

KOGO Studio Indonesia presents

# 2025 Beginner Study Group



Your Path to Mastering Korean Starts Here

>>>

## Background

### KOGO Study Group

As education practitioners and students ourselves, we recognized that the main goal for us, as students, is to maintain and upgrade our Korean skills, expose ourselves to all Korean language learning aspects (writing, speaking, listening, reading, grammar), commit to practicing outside the class, and understanding real situations in various contexts, and the lack of trusted discussion platform. With this in mind, KOGO Studio team tried to create a study group within our team, and setting clear goals and points we wanted to achieve, planning a learning schedule along with the tasks to test out. With multiple times of discussions, failed trials and successful trials, here we have seen significant improvement in our skills through certain approaches.

And finally, in 2025, we are excited to offer this Study Group to everyone learning Korean and anyone who wants to learn more comprehensively. We are ready to provide a platform for growth, with our team, and with our dedicated teachers 😊

## About

### KOGO Study Group

**KOGO Study Group** is a **Korean language learning group with a community-based approach, managed by KOGO Studio academic team with trained & certified Korean language teachers.** Students who enroll in this program will be able to join **thematic community classes**, which is a supplementary, interactive learning session held **LIVE by Zoom**, focused on specific topics to enhance Korean language skills. Led by certified teachers, these classes include activities like grammar exercises, vocabulary building, speaking practice, and real conversations with native speakers, offering direct feedback and addressing common challenges faced by learners.

Additionally, participants of KOGO Study Group will enjoy **other exclusive benefits**, such as:

- **Online Q&A** with teachers (on Platform)
- **Recording access** to some thematic classes (on Platform)
- Access to **Info sessions** with KOGO Education (Zoom Live)
- **KOGO Talks** and **KOGO Sharing Sessions** (Zoom Live)

## KOGO Beginner Study Group

# Programs & Features

### Thematic Community Classes with Teachers



**Thematic Community Class** in KOGO Study Group is a supplementary class, which will be held LIVE via Zoom and focus on group discussions led by certified and professional teachers. These thematic classes, which include **Grammar Exercises, Vocabulary Improvement, Speaking Practice, Cultural Class and Live Conversations with Native Teachers, are designed to enhance students' Korean language skills.**

It's important to note that the thematic classes in the KOGO Study Group are not standalone. Our academic team has formulated these classes into a comprehensive supplementary curriculum to fill the gaps not covered in detail and provide a deeper understanding beyond the contents offered in the main courses. Therefore, this program does not eliminate the need to take the main classes.

Practicing in thematic classes is designed to address common challenges faced by Korean language learners, with topics of interest such as:

- Common mistakes in Korean grammar usage
- Group challenge with teacher's accompaniment
- Group discussion and presentation
- In-depth discussions on specific topics with related vocabulary and expressions
- Real Korean conversations on particular topics, along with direct practice
- Get to know Korean culture and real situation
- TOPIK questions discussions, and much more.

### Class Recording Access



Students in the study group **will have the access** to some community class / info sessions recordings **for up to two weeks** after they are uploaded (viewable online, no download option), while practice and conversation classes will not be recorded.

KOGO Beginner Study Group  
**Programs & Features**

Online Q&A Platform



For an additional support, the students will have access in our website where **the students can ask questions and get answers from KOGO teacher in charge**. This feature ensures that learning continues outside of the class, and that students can clarify doubts as they progress through their learning journey.

Every week, our team will post a Q&A thread where students can ask questions and help each other. The teacher in charge will respond to the questions and discussions happened in the thread. **Students can also ask questions privately through the website chat**, and our teacher will respond within the week.

Exclusive Info Session



Students will gain **access to special info sessions** that provide **valuable insights in studying in Korea**. These sessions will cover a variety of topics, including admissions to Korean universities, introduction directly by the Universities, available scholarships, about GKS, important tips, and even image of living and studying in Korea, all provided by KOGO Education team.

Sharing Sessions & Community Engagement



Signature events by KOGO Studio, where **we invite speakers or teachers to share their experiences and facilitate open discussions with our students**. The study group fosters a sense of community among learners, with opportunities for students to share their experiences, tips, and cultural insights, creating a supportive and engaging atmosphere for everyone involved.

## 2025 Schedule

Month	Community Class & Events
<b>March</b>	TOPIK 101 & Tips on preparing TOPIK
	Numbers & Counting unit Practice
	TOPIK 1 Part 1
	TOPIK 1 Part 2
	TOPIK 1 Part 3
	TOPIK 1 Part 4
	Table Manner in Korea
	Verbs & Adjectives for Beginner
	Ordering foods in Korea
	Conversation Practice : Ordering foods in Korean
	<b>April</b>
TOPIK 1 Part 5	
TOPIK 1 Part 6	
TOPIK 1 Part 7	
TOPIK 1 Part 8	
Grammar Practice : -에 v.s. -에서	
Differences between similar 'future tenses'	
Making appointment	
Conversation Practice : Making appointment	
GKS 2026 Timeline Set-up	
<b>May</b>	
	Grammar Practice : Past tense

## 2025 Schedule

Month	Community Class & Events
<b>May</b>	Good habits in Korean
	Suggesting in Korean
	Sickness in Korean
	Grammar Practice : -고
	Expressions used in Hospital for Beginner
	Conversation Practice : Health
	Setting Learning Goals in Korean Learning Journey
<b>June</b>	Places in Korean
	Grammar Practice : -로
	Preposition practice
	Directions in Korean
	Conversation Practice : Looking for direction
	Pronunciation Practice
	Self Introduction in Korean
	Conversation Practice : Self Introduction
	Info Session by KOGO Education
	Avoiding beginner mistakes
<b>July</b>	Period of time in Korean
	Grammar Practice : 이/가 v.s. 은/는 for Beginner
	Hobbies in Korean
	Conversation Practice : Spare-time activities
	Sentence Making : 그리고, 그래서, 그런데

## 2025 Schedule

Month	Community Class & Events
<b>July</b>	Planning in Korean
	Grammar Practice : 후 & 전
	Conversation Practice : Weekend Plan
	Info Session by KOGO Education
	How to Self Study + tips
<b>August</b>	TOPIK 1 Part 1
	TOPIK 1 Part 2
	TOPIK 1 Part 3
	TOPIK 1 Part 4
	Pronunciation Practice
	Expressing intention in Korean
	Grammar Practice : -아/어 보다
	Signage in Public Places in Korea
	Conversation Practice : Cultural differences
	Grammar Practice : -아/어도 되다 & -(으)면 안 되다
	GKS Q&A by KOGO Education
	Navigate in Korea + traveling tips
<b>September</b>	TOPIK 1 Part 5
	TOPIK 1 Part 6
	TOPIK 1 Part 7
	TOPIK 1 Part 8
	Weather and Seasons in Korea for Beginner



## 2025 Schedule

Month	Community Class & Events
<b>September</b>	Pronunciation Practice
	Grammar Practice : 때
	Conversation Practice : Winter / Summer Activities
	Grammar Practice : -지만
	Info Session by KOGO Education
	Boosting Korean Conversation
<b>October</b>	Irregular Verbs & Adjectives
	Grammar Practice : -(으)ㄴ 수 있다 / 없다
	Conversation Practice : Abilities
	Colors & Patterns in Korean
	Describing Clothes
	Grammar Practice : 안 & 못
	Shopping in Korean
	Conversation Practice : Ideal type
	Info Session by KOGO Education
	Chuseok in Korea
<b>November</b>	Pronunciation Practice
	Grammar Practice : Noun modifier
	Jobs in Korean
	Conversation Practice : Professions
	Greeting in Korean
	Grammar Practice : -아/어서 v.s. -(으)니까

## 2025 Schedule

Month	Community Class & Events
November	Politeness in Korean
	Conversation Practice : Formal Occasions
	Info Session by KOGO Education
	Planning ahead your Korean Learning Journey in 2026
December	Grammar Practice : -고 있다
	Holidays in Korea
	Sending wishes in Korean
	Christmas & New Year Culture in Korea
	Grammar Practice : 무슨 & 어떤
	Additional noun : 하고, 화/과, 량/이랑
	Telling Future Plan
	Conversation Practice : Next year plans
	GKS Q&A by KOGO Education

- **A detailed schedule will be available one week before the start of the month.**
- The schedule above is fixed; however, the class or event name is subject to adjustment.
- We reserve the right to modify the subject to better meet students' needs, with prior notice.
- All sessions will be held LIVE via Zoom with KOGO teachers.
- All session details will be available on the community page.
- Not all sessions will be recorded.



## Access Plan

Monthly

250,000

4-Month Access

730,000

2025 Full Access

1,600,000

(Mar - Dec 2025)

March Trial Price : 150,000!

## KOGO Students Special Price

Monthly

200,000

4-Month Access

660,000

2025 Full Access

1,300,000

(Apr - Dec 2025)

**FREE TRIAL FOR KOGO STUDENTS (whole march)**

### 2025 Full Access Benefits (March Purchase) :

- KOGO 2025 Planner
- KOGO Education Special Price
- KOGO Experience Special Price

## How to redeem free trial & gain special price

**FREE TRIAL** : Chat and ask our Class Coordinator to be invited to the Study Group in March.

**SPECIAL PRICE** : Chat and ask our Class Coordinator for designated promo-code for KOGO Study Group.

# Study Group Access

KOGO study group access will open one week before the start of the month, along with the detailed schedule. Options include a monthly package, a 4-month package, and a package for the remainder of the year.

KOGO Study Group access is **available exclusively** through **our website**.

## How to Book

To Access, kindly visit :  
[www.koreanglobalstudio.com/study-groups](http://www.koreanglobalstudio.com/study-groups)

1. Sign up / Log-in to our website
2. Go to [www.koreanglobalstudio.com/study-groups](http://www.koreanglobalstudio.com/study-groups)
3. Join 'Beginner Study Group'
4. Choose 'Get Plan'
5. Choose Access Plan suitable for you
6. Fill out the application
7. Payment
8. You are ready to go! 🙌🙌

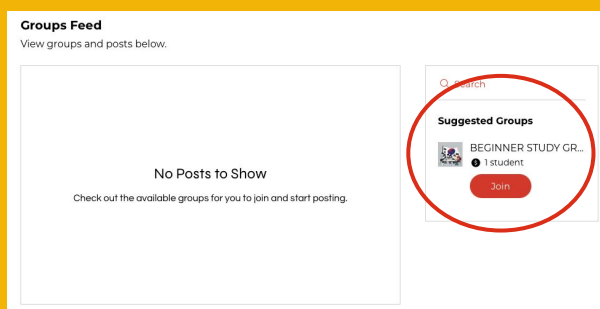

The screenshot shows the 'Sign Up' form with fields for ID name, Email, WhatsApp, and Birthday. There are checkboxes for 'Language Learning Reasons' such as 'Language enthusiast', 'Study abroad', 'Work relation', 'Family', 'K-pop enthusiast', 'K-drama enthusiast', 'Travel', and 'Other'. An 'Order summary' section on the right shows 'BEGINNER STUDY GROUP (MARCH TRIAL)' for IDR 150,000.00.

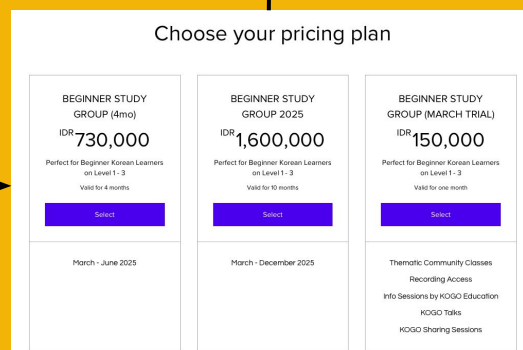
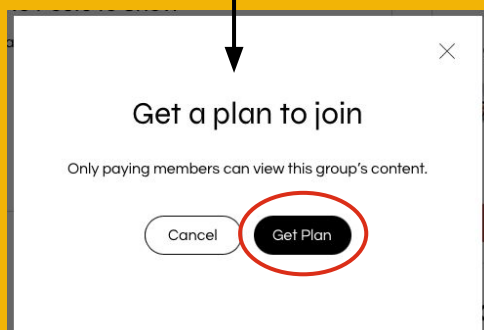

## Community Guideline

To ensure everyone has a positive experience, please familiarize yourself with our community guidelines:

**1. Be respectful:** Treat others with kindness, empathy, and understanding. Everyone has a different point of view so feel free to respectfully disagree. Please be kind and courteous at all times.

**2. Stay on topic:** Keep discussions relevant to the study group's focus.

**3. Share knowledge:** Contribute your insights, experiences, and expertise. Don't forget to include sources and refrain from offering thoughts that you're uncertain about. You can ask to our teacher about your uncertainties.

**4. Ask Questions:** Don't hesitate to ask for clarification or help from our community and KOGO teachers. Please ask questions in the question box that we will prepared every week.

**5. No Spam or Self-Promotion:** Please refrain from posting unsolicited advertisements, self-promotional content, or spam. While recommending relevant topics is welcome, any form of direct selling or unsolicited promotion is not permitted.

**6. Respectful Interaction:** We value a respectful and supportive environment. Bullying, targeting, or attacking other members will not be tolerated. Any such behavior will result in immediate removal from the group.

**7. KOGO Studio's Marketing Post:** KOGO Studio is allowed to share support materials or classes, but we will not exert any selling pressure. Any member engaging in inappropriate sales tactics or promotional behavior will be removed.

**8. Report Discomfort:** If you experience any discomfort while engaging in the community, please reach out to us directly. We're here to help ensure everyone feels welcome and safe.

**9. Respect intellectual property:** When sharing others people's posts, images and other content, do not infringe on their copyright or claim other people's materials as your own.

**10. KOGO Studio's Content Right :** All learning materials shared in the Study Group are owned by KOGO Studio, and only paid members are able to access them. Sharing KOGO's content outside the community is prohibited.

# Frequently Asked Questions

## **What's the difference between KOGO study group and KOGO practice class?**

Both have different focuses. KOGO Practice Class is an intimate and comprehensive learning experience with clear goals and a structured curriculum at every level. On the other hand, KOGO Study Group is a topic-based study group that caters a wider range of levels (Level 1-3).

## **What's the difference between this community class with all KOGO courses?**

Both have different goals. KOGO Studio courses focus on building strong foundations for our students, while community classes in the KOGO Study Group are designed to maintain and expand students' knowledge. We recommend combining both the courses and the Study Group for the best result. Please contact our Customer Service if you need any help or further assistance.

## **What's the difference between KOGO's TOPIK I Preparation Class with community class in KOGO study group?**

Our original TOPIK I Practice Class is an intimate and in-depth preparation course for TOPIK I, while the TOPIK I community classes in the KOGO Study Group are one-hour sessions focused on solving TOPIK I practice problems.

## **Do you still have free events after this?**

Yes, we will continue to offer some of our community programs as free public events at least once a month. However, recording access will only be available to community members.

## **Can I join this Study Group even though I am currently doing a self-study / studying in other place?**

**Sure!** Everyone who is learning Korean Language in Beginner Stage (KOGO Level 1~3) is welcomed to join. Check your level for free [HERE](#).

## **Is this study group a safe place to new Korean Language learners?**

Yes, it is. However, we always recommend that you learn and practice related grammars, vocabularies, and expressions before joining our community class to get the most out of your learning experience.

## **Why can't we access the recording for practice & conversation classes?**

Our practice and conversation classes are designed to be fully interactive, encouraging active participation between students and the teacher. It encourages the students to engage and actively practice during the class, rather than passively watching through video recordings.

## **How many students will be in one community class?**

We will accept up to 95-98 students in one class, and currently, our study group is open to a maximum of 100 students. Any changes to this limit will be communicated accordingly.

## **How to maximize the use of KOGO Study group?**

We recommend preparing the related study materials before joining any classes and actively participating in all class activities.

# Frequently Asked Questions

## **Can I send my questions to the teachers 24/7?**

Yes, but the teacher may not be able to respond in real-time. We assure you that every student in the KOGO Study Group will receive an answer, but please expect a delay in replies. The Q&A section will be open every week on the community page, and all members can also ask questions privately through the website chat box.

## **Can I use my account together with my friends?**

No, it is prohibited and against our rules to share one account with multiple people. If we discover such activity, immediate expulsion and banning from the study group community will occur.

## **Is it refundable?**

No, all access packages are non-refundable for any reason.

## **Do you have any plan for higher levels of KOGO Study Group?**

If we succeed in 2025, we may consider opening higher levels of the KOGO Study Group.

## **What to expect from this Study Group Community?**

Other than the classes we provide, we are eager to foster community behavior as below :

- Engaging discussions about Korean Language and related topics.
- Collaborative learning and knowledge-sharing.
- Supportive and encouraging community members.
- Regular updates of classes, resources, and study materials.

## **JOIN KOGO BEGINNER STUDY GROUP**

**CLICK HERE**

If you need further assistance, **Chat our team here**

Customer Service : +62821-2221-8017